

TYPICAL FLOOR PLAN  
**1-TENANT, PARTITIONED**

MILLENNIUM TOWER

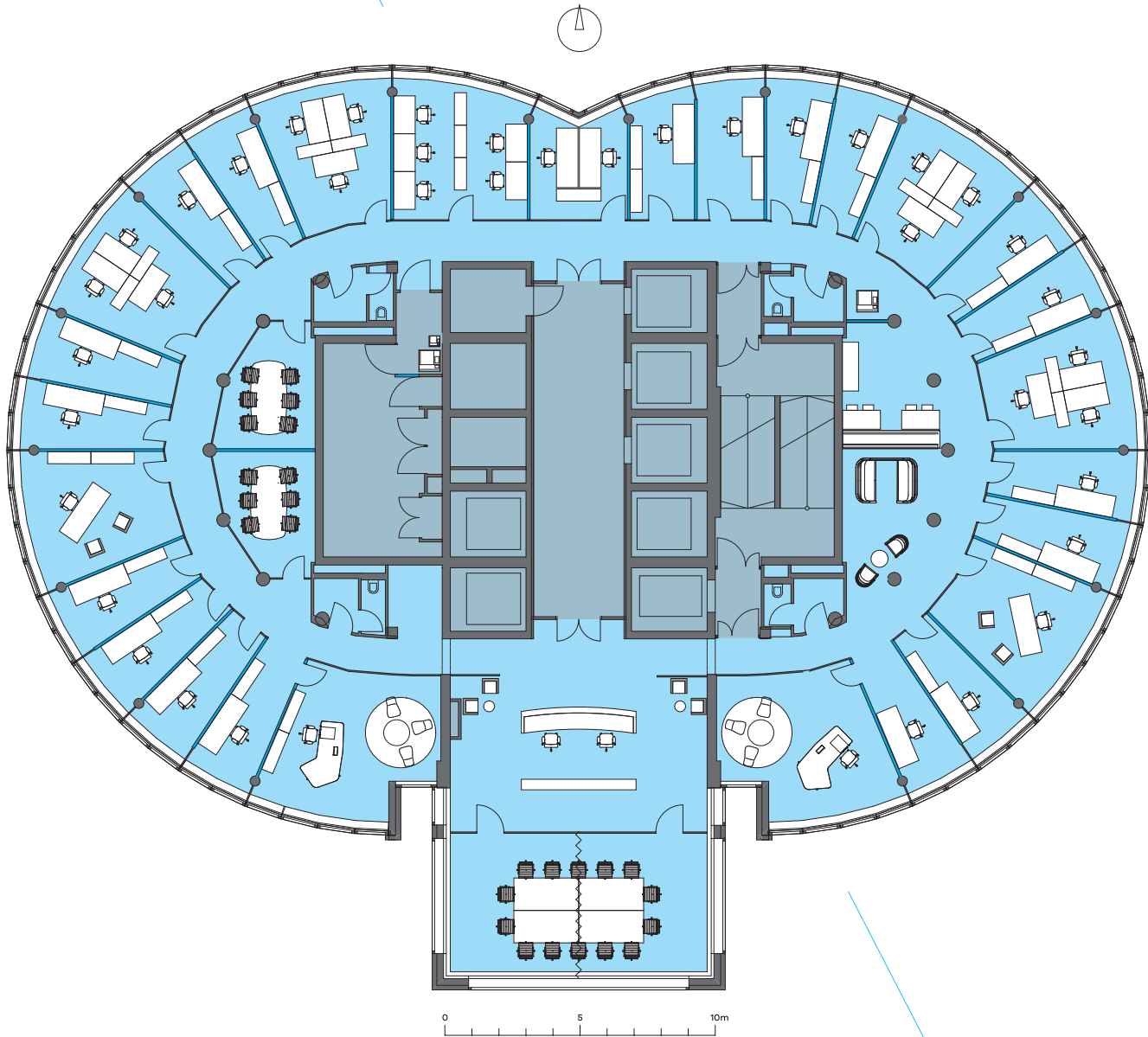

TOTAL LETTABLE AREA

**887.16 sq m**

VERMIETBARE GESAMTFLÄCHE

NO. OF WORKING SPACES

**43**

ANZAHL ARBEITSPLÄTZE

RATIO SQ M PER WORKING SPACE

**20.6 sq m**

VERHÄLTNIS M<sup>2</sup> PRO ARBEITSPLATZ